

BUSH REF. 803

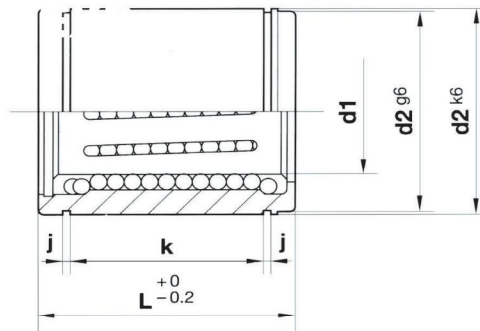

BOLEXP 803							
d1	L	d2	k	j	Ø ball	Number of lines	Item code
12	30	24	20	1,3	3	5	B8031230
16	30	28	19	1,6	3	6	B8031630
16	35	28	24	1,6	3	6	B8031635
20	35	32	24	1,6	3	6	B8032035
20	45	32	34	1,6	3	6	B8032045
25	35	40	23	1,8	3	8	B8032535
25	45	40	33	1,8	3	8	B8032545
25	55	40	43	1,8	3	8	B8032555
32	45	50	33	2,1	4	8	B8033245
32	63	50	51	2,1	4	8	B8033263
40	45	60	33	2,1	4	8	B8034045
40	63	60	51	2,1	4	8	B8034063
50	63	70	50	2,6	4	10	B8035063
50	80	70	65	2,6	4	10	B8035080
60	80	85	65	3,1	4	12	B8036080
60	100	85	85	3,1	4	12	B80360100

Materials: Special steel bush. Bronze cage with high resistance to wear. High-precision balls. Hardness: 60-62 HRc.

COLUMN REF. 808



BOLEXP 808						
d1	L	d2	a	b	c	Item code
8	60	12	3	4	10	B80808060
8	80	12	3	4	10	B80808080
8	100	12	3	4	10	B80808100
10	60	14	4	4	12	B80810060
10	80	14	4	4	12	B80810080
10	100	14	4	4	12	B80810100
12	80	16	4	4	16	B80812080
12	100	16	4	4	16	B80812100
12	125	16	4	4	16	B80812125
16	80	20	6	6	20	B80816080
16	100	20	6	6	20	B80816100
16	125	20	6	6	20	B80816125
16	160	20	6	6	20	B80816160
16	200	20	6	6	20	B80816200
20	100	24	6	6	22	B80820100
20	125	24	6	6	22	B80820125
20	160	24	6	6	22	B80820160
20	200	24	6	6	22	B80820200
20	250	24	6	6	22	B80820250
25	125	30	6	6	25	B80825125
25	160	30	6	6	25	B80825160
25	200	30	6	6	25	B80825200
25	250	30	6	6	25	B80825250
25	315	30	6	6	25	B80825315
32	125	37	8	8	35	B80832125
32	160	37	8	8	35	B80832160
32	200	37	8	8	35	B80832200
32	250	37	8	8	35	B80832250
32	315	37	8	8	35	B80832315
40	125	45	8	8	35	B80840125
40	200	45	8	8	35	B80840200
40	250	45	8	8	35	B80840250
40	315	45	8	8	35	B80840315
40	400	45	8	8	35	B80840400
50	315	55	10	10	45	B80850315
50	400	55	10	10	45	B80850400
60	315	65	10	10	55	B80860315
60	400	65	10	10	55	B80860400

Materials: Steel 5732 Hardness: 62-64 HRc.

Please ask for other diameters and lengths different to the ones included in this catalogue.